

Google Classroom

**If you already have an existing google account, then you can add the classroom using the steps from the sign-in steps.

Got to: <https://accounts.google.com/Login>

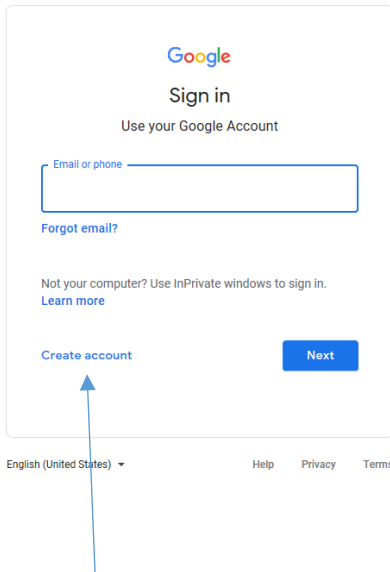

Click create account.

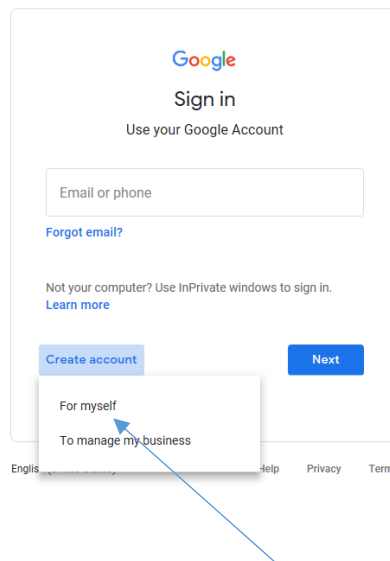

Choose 'for myself'.

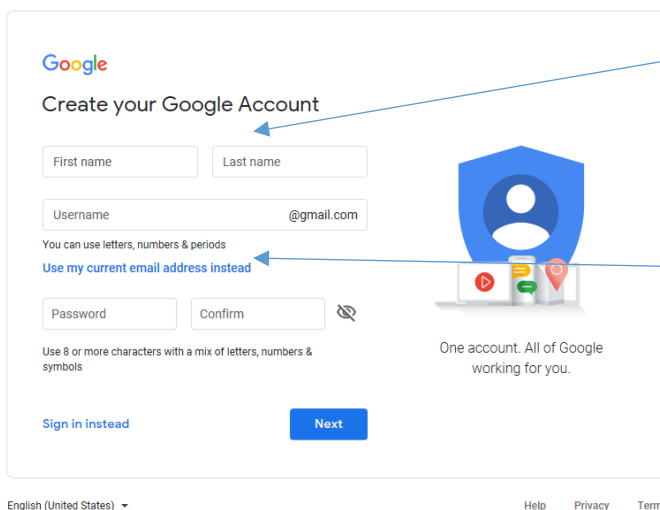

Enter pupil first and last name.

Then click use my current email address instead.

Google

Create your Google Account

First name

Last name

Your email address

You'll need to confirm that this email belongs to you.

[Create a new Gmail address instead](#)

Password

Confirm

Use 8 or more characters with a mix of letters, numbers & symbols

[Sign in instead](#)

English (United States) ▾

[Help](#) [Privacy](#) [Terms](#)

Type in current email address and create password. Click Next.

Google

Verify your email address

Enter the verification code we sent to parentdemonstration@outlook.com. If you don't see it, check your spam folder.

Enter code

[Back](#)

English (United States) ▾

[Help](#) [Privacy](#) [Terms](#)

Verify email address with code sent to email account. Type in code then click Verify.

If you can't see an email in your inbox, check junk mail.

Verify this email is yours

parentdemonstration@outlook.com

This email address was recently entered to verify your email address.

You can use this code to verify that this email belongs to you.

538028

If this wasn't you, someone may have mistyped their email address. Keep this code to yourself, and no other action is needed at this moment.



Pupil First Name, welcome to Google

parentdemonstration@outlook.com

Phone number (optional)

We'll use your number for account security. It won't be visible to others.

Month Day Year

Your birthday

Gender

[Why we ask for this information](#)

[Back](#)

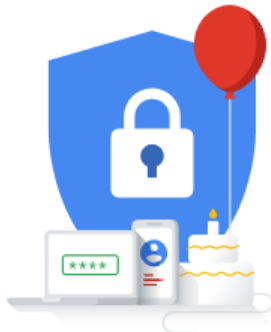

Your personal info is private & safe

English (United States) [Help](#) [Privacy](#) [Terms](#)

Insert information here - Mobile Number (optional), D.O.B. (must be parent or guardian) and Gender. Click Next.

Follow the next set of instructions on-screen until your account set-up is completed.

**

Now sign in to your google account. Enter email. Click Next. Enter Password. Click Next.

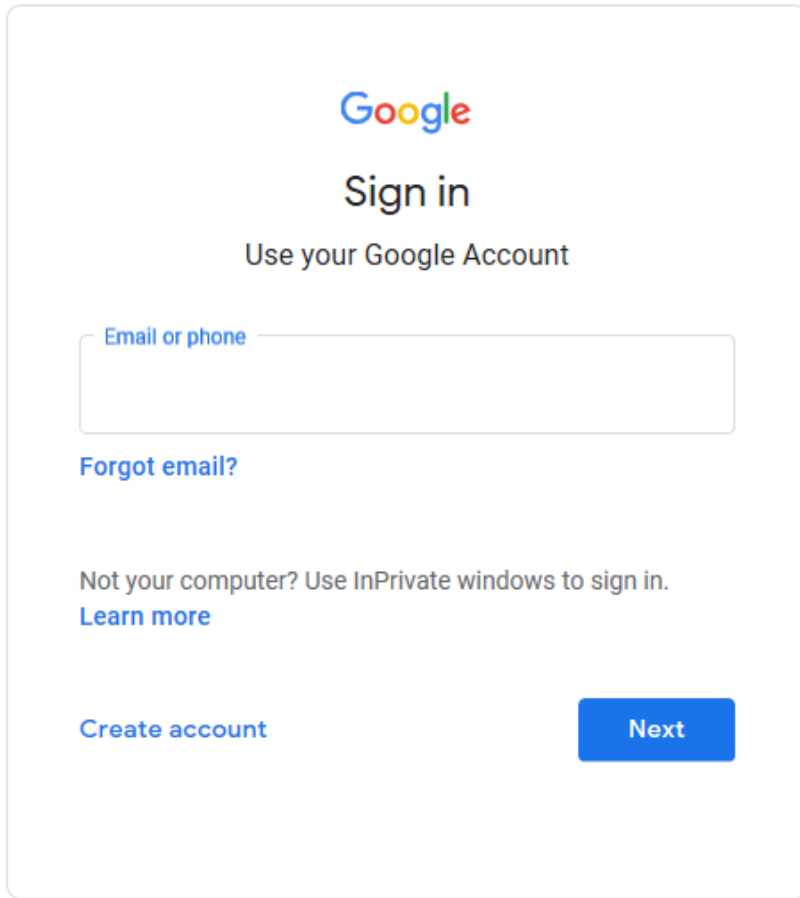

English (United States) ▾

Help

Privacy

Terms

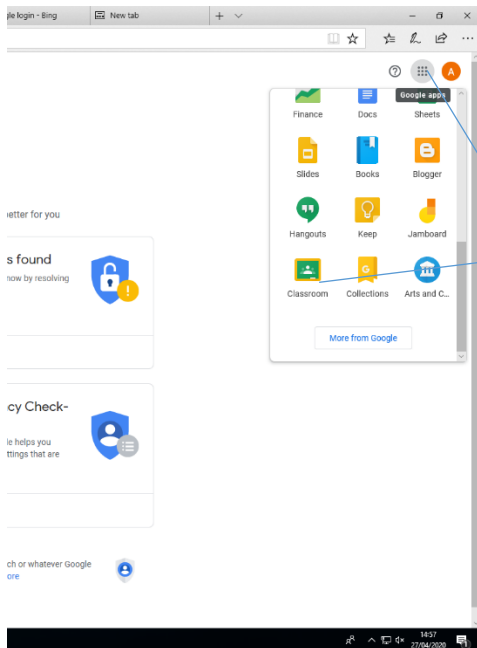

Click on Google Apps icon. Select Classroom.

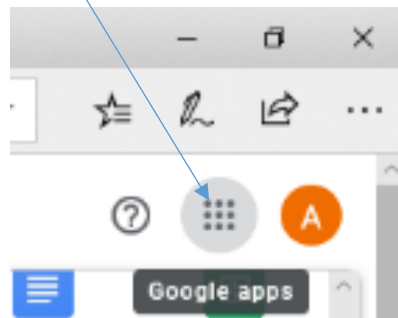

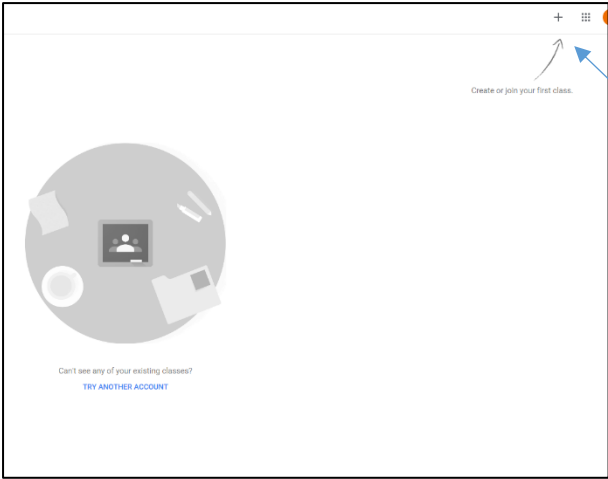

Click on the + sign to join classroom. Click join class.

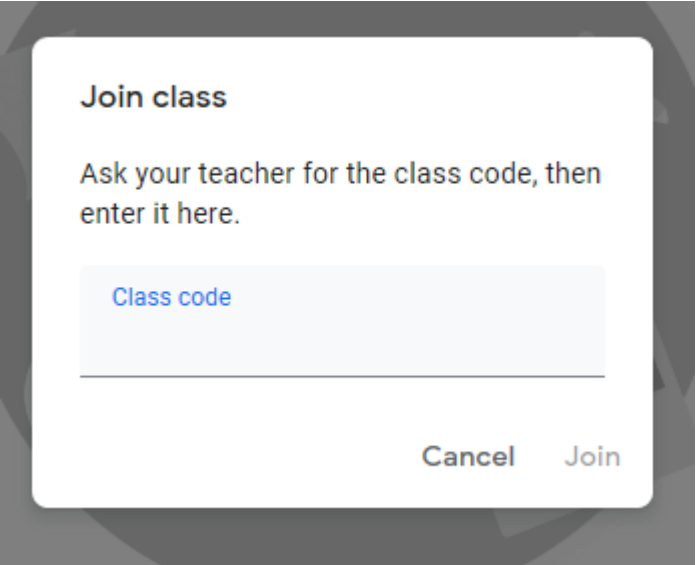

Enter the class code which has been provided by school. Click join.

You should then be in the classroom set by your teacher.
